

Close to the station

Subway
ROPPONGI
remm



Facility overview **All rooms non-smoking**

- Total number of guest rooms: 400
- Economy double rooms: 320
- Twin rooms: 80
- The hotel also has a ladies only floor.
- Drink vending and VOD ticket machines are located on each floor.
- 4 ice machines

[Location of rooms and facilities]

- 1F Hotel main entrance
- 2F Breakfast restaurant
- 4F Reception, Lobby, Nursing room, Smoking boot
- 5F - 20F Guest rooms

Check-in time : 14:00

Check-out time : 12:00

Directions

- From nearest station
 - Hibiya Line Roppongi Station (H4) 4a Exit (1 minute walk)
 - Toei Oedo Line Roppongi Station (E23) No.7 Exit (1 minute walk)
 - Chiyoda Line Nogizaka Station (C05) No.3 Exit (7 minute walk)
- From Tokyo Station (15 minutes)
 - Marunouchi Line via Kasumigaseki Station, Get off Hibiya Line Roppongi Station
- From Haneda Airport (40 minutes)
 - Keikyu Line via Daimon Station, Get off Toei Subway Oedo Line Roppongi Station
- From Narita Airport (90 minutes)
 - JR Narita Express (N'EX) via Tokyo station, Get off at Roppongi Station

Map

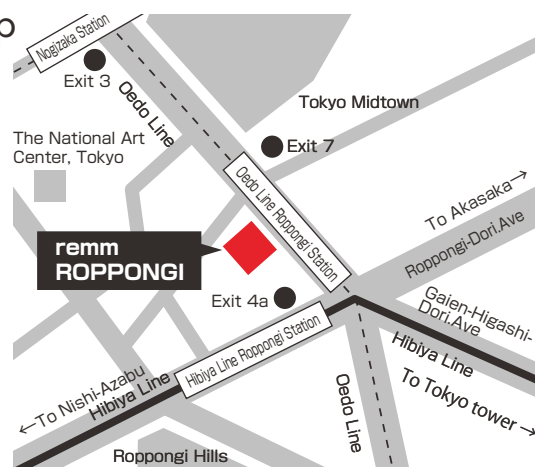

Basic information

remm ROPPONGI

7-14-4 Roppongi, Minato-ku, Tokyo, 106-0032

TEL:+81-(0)3-6863-0606 (Reception) FAX:+81-(0)3-6863-0607

All guest rooms

- *remm original bed [Silky remm] *Massage chair, 40-inch LCD TV
- *Rain shower, Air purifier *Complimentary Wi-Fi and wired LAN
- *Mineral water : 1 bottle free per person *Safetybox
- *Ceiling mounted nanoe generator [aia-e]



remm plus Ginza
TEL:+81-(0)3-6866-0606
JR-Subway Shimbashi Station
(4 minute walk)
Subway Ginza Station
(7 minute walk)



remm Tokyo Kyobashi
TEL:+81-(0)3-6843-0606
Subway Kyobashi Station
Right by Exit No. 6
JR Tokyo Station (7 minute walk)



remm Hibiya
TEL:+81-(0)3-3507-0606
JR Yurakucho Station (4 minute walk)
Subway Hibiya Station (3 minute walk)
Subway Ginza Station (5 minute walk)



remm Akihabara
TEL:+81-(0)3-3254-0606
Direct connection from
JR Akihabara Station
central exit



remm Shin-Osaka
TEL:+81-(0)6-7668-0606
Direct connection from
JR-Subway
Shin-Osaka Station.



remm Kagoshima
TEL:+81-(0)99-224-0606
Tram Tenmonkan-dori
train stop
(1 minute walk)

Guest room Total guest rooms: 400



Economy double room

Space : 15.0 m² Bed : W1,400mm×D1,950mm
No bath tub, contains shower booth
Contains glass partition



Twin room

Space : 24.4 m² Bed : W1,100 mm×D2,000 mm
Contains bath tub
Contains glass partition

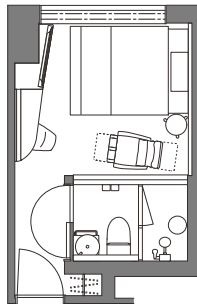

< Economy double room example >

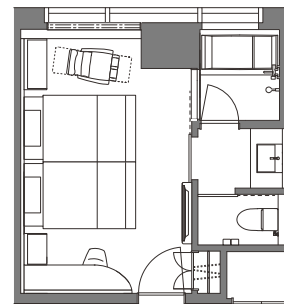

< Twin room example >

Item Experiencing the ultimate in relaxation



Rain shower

The water flowing down from the large TOTO shower head gently envelops your entire body. Enjoy while relaxing on the stool provided.



Remm original bed Silky remm

A specially-designed bed developed in collaboration with NIHON BED. Featuring an ultra-high density structure with twice the number of springs in a normal bed. Come to remm and experience a wonderful sleep.



Massage chair

Please enjoy a firm, smooth, thumb-like, massage, using the horizontally-rotating-massaging-balls, a new concept by Daito Electric Machine Industry.



Remm original Bath amenities

Remm original Bath amenities
[Shampoo and conditioner] The organic chamomile extract and amino acid components of our shampoo and conditioner.
[Bath and shower gel] The dense, rich bubbles of our organic olive oil formula with sweet almond fragrance.



Pillow selection

All customers can choose from two types of pillows; the remm original "sound sleep function pillow," or the tempur "traditional pillow." We also have several other types of pillows available to guests according to their preference.

CEDAR [CEDAR THE CHOP HOUSE & BAR]



Offering a warm, modern, refined dining experience while maintaining a regular easy-going feel, not unlike the design diners of Midtown New York. Here you can relax in comfort while experiencing the vibrant feel of the open kitchen.



[Breakfast hours]
6:30 a.m. - 10:30 a.m. (L.O. 10:00 a.m.)
[Charge]
Hotel guests 1,850 yen (non-guests 2,050 yen)
* includes tax
[Breakfast menu]
Japanese & Western Buffet